



Submittal Data Information

101-031

Model 008 Cartridge Circulator

Effective: May 8, 2009

Supersedes: September 1, 2003

Job: _____ Engineer: _____ Contractor: _____ Rep: _____

| ITEM NO. | MODEL NO. | IMP. DIA. | G.P.M. | HEAD/FT. | H.P. | ELEC. CHAR. |
|----------|-----------|-----------|--------|----------|------|-------------|
| | | | | | | |

Features

- Standard High Capacity Output-Compact Design
- Quiet, Efficient Operation
- Direct Drive-Low Power Consumption
- Unique Replaceable Cartridge Design-Field Serviceable
- Self Lubricating
- No Mechanical Seal
- Unmatched Reliability-Maintenance Free
- Universal Flange to Flange Dimensions
- Cast Iron or Stainless Steel, Flanged or Bronze, Sweat Connections

Application

The Taco 008 is designed for a wide range of residential and light commercial higher-head water circulating applications. Typical uses include hydronic heating, radiant in-floor/panel heating and closed-loop solar heating systems. The Stainless Steel or Bronze 008 can be used in higher-head heat recovery, water source heat pump, open-loop solar heat and domestic water recirculation systems. The unique replaceable cartridge contains all of the moving parts and allows for easy service, instead of replacing the entire circulator. Compact, direct-drive, low power consumption design is ideal for high-efficiency jobs.

Pump Dimensions & Weights

| Model | Casing | A | | B | | C | | D | | F | | G | | Ship Wt. | |
|---------|-----------|-------|-----|--------|-----|--------|----|---------|----|-------|-----|-------|-----|----------|-----|
| | | in. | mm | in. | mm | in. | mm | in. | mm | in. | mm | in. | mm | lbs. | Kg |
| 008-F6 | Cast Iron | 6 | 152 | 4 | 102 | 3-3/16 | 81 | 2-15/16 | 75 | 4-3/4 | 121 | 6-3/8 | 162 | 8.0 | 3.6 |
| 008-SF6 | St. Steel | 6 | 152 | 4 | 102 | 3-3/16 | 81 | 2-15/16 | 75 | 4-3/4 | 121 | 6-3/8 | 162 | 8.0 | 3.6 |
| 008-BC6 | Bronze | 5-5/8 | 143 | 4-9/16 | 116 | 3-3/16 | 81 | 2-15/16 | 75 | 4-3/4 | 121 | 6-3/8 | 162 | 8.0 | 3.6 |

Materials of Construction

| | |
|-------------------|--|
| Casing (Volute): | Cast Iron or St. Steel, Flanged Bronze, Sweat |
| Stator Housing: | Steel |
| Cartridge: | Stainless Steel |
| Impeller: | Non-Metallic |
| Shaft: | Ceramic |
| Bearings: | Carbon |
| O-Ring & Gaskets: | EPDM |

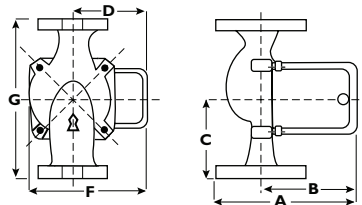

Mounting Positions

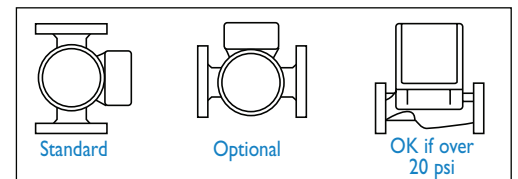

Model Nomenclature

- F – Cast Iron, Flanged
 - SF – Stainless Steel, Flanged
 - BC – Bronze, 3/4" Sweat Connections
- Variations:**
- Z – Zoning Circulator
 - J – Bronze Cartridge with Cast Iron Casing

Electrical Data

| Model | Volts | Hz | Ph | Amps | RPM | HP |
|---------|-------|----|----|------|------|------|
| 008-F6 | 115 | 60 | 1 | .79 | 3250 | 1/25 |
| 008-SF6 | 115 | 60 | 1 | .84 | 3250 | 1/25 |
| 008-BC6 | 115 | 60 | 1 | .84 | 3250 | 1/25 |

Motor Type: Permanent Split Capacitor
Impedance Protected

Motor Options: 220/50/1, 220/60/1, 230/60/1, 100/110/50/60/1

Flange Orientation

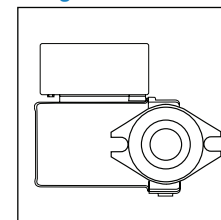

Performance Data

- Flow Range: 0 – 14 GPM
- Head Range: 0 – 16 Feet
- Minimum Fluid Temperature: 40°F (4°C)
- Maximum Fluid Temperature: 230°F (110°C)
- Maximum Working Pressure: 125 psi
- Connection Sizes: 3/4", 1", 1-1/4", 1-1/2" Flanged, 3/4" Sweat



FOR INDOOR USE ONLY

Performance Field - 60Hz

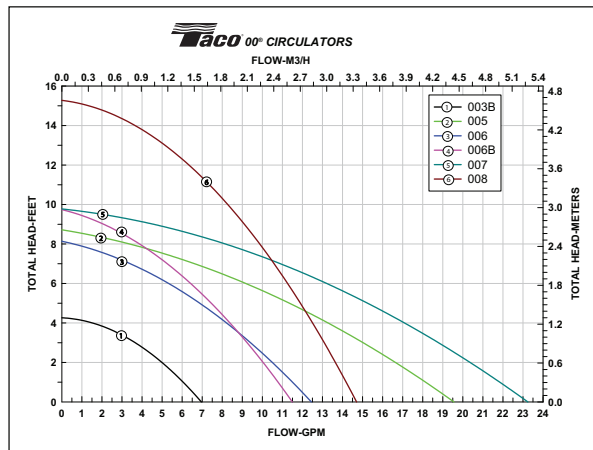

Taco, Inc., 1166 Cranston Street, Cranston, RI 02920 | Tel: (401) 942-8000 | FAX: (401) 942-2360

Taco (Canada), Ltd., 8450 Lawson Road, Suite #3, Milton, Ontario L9T 0J8 | Tel: (905) 564-9422 | FAX: (905) 564-9436

Visit our web site: www.TacoComfort.com | Printed in USA | ©2015 Taco, Inc.

