

INSTALLATION INSTRUCTIONS

LOW PRESSURE CONTROL PACKAGE

RXAC-C01

2 THROUGH 4 TON R410A UNITS

Package Air Conditioners

Package Gas Electric Units

(Do not use for other units unless compatibility is first assured by Purchaser.)

▲ WARNING

THIS ACCESSORY IS INTENDED FOR USE BY A QUALIFIED, LICENSED SERVICE PERSON. TO AVOID UNSATISFACTORY OPERATION OR DAMAGE TO THE PRODUCT AND POSSIBLE UNSAFE CONDITIONS, INCLUDING ELECTRICAL SHOCK, REFRIGERANT LEAKAGE AND FIRE, THE INSTALLATION INSTRUCTIONS PROVIDED WITH THIS ACCESSORY MUST BE STRICTLY FOLLOWED AND THE PARTS SUPPLIED USED WITHOUT SUBSTITUTION. DAMAGE TO THE PRODUCT RESULTING FROM NOT FOLLOWING THE INSTRUCTIONS OR USING UNAUTHORIZED PARTS IS EXCLUDED FROM THE MANUFACTURER'S PRODUCT WARRANTY COVERAGE.

| PARTS LIST | | |
|----------------------|--------------|------|
| Description | Part Number | Qty. |
| Low Pressure Control | 47-100571-03 | 1 |
| Wire Nut | 45-18058-01 | 2 |
| Wire Tie | 64-17606-01 | 3 |
| Cover, Flag Terminal | 45-21684-01 | 2 |
| Instructions | 92-22033-08 | 1 |

▲ WARNING

BEFORE BEGINNING ANY MODIFICATION, BE SURE THE MAIN ELECTRICAL DISCONNECT SWITCH IS IN THE "OFF" POSITION. TAG DISCONNECT WITH A SUITABLE WARNING LABEL.

1. INSTALLATION PROCEDURE

▲ CAUTION

WHEN MAKING FLARE CONNECTIONS, USE A BACK-UP WRENCH TO AVOID BREAKING CONNECTION OR SPLITTING FLARE.

- A. Remove access panel to control box. Lift top condenser fan assembly from condenser section and place aside to allow working space.
- B. Refer to Figure 1 for location of low pressure control.
 1. Secure low pressure control to the liquid line process tube with wire tie.

2. Connect the low pressure capillary tube (flare fitting) to the suction line schrader fitting.

- C. Check refrigeration connection for leaks and repair as necessary.

2. ELECTRICAL CONNECTION

- A. Please refer to the wiring diagram with the unit and to Figure 2 for the proper connections.
- B. Tie into yellow lead from control box as shown.
- C. Reinstall condenser fan assembly, control box cover and all access panels.
- D. Restore power to the unit and check operation.

FIGURE 1
LOW PRESSURE CONTROL INSTALLATION

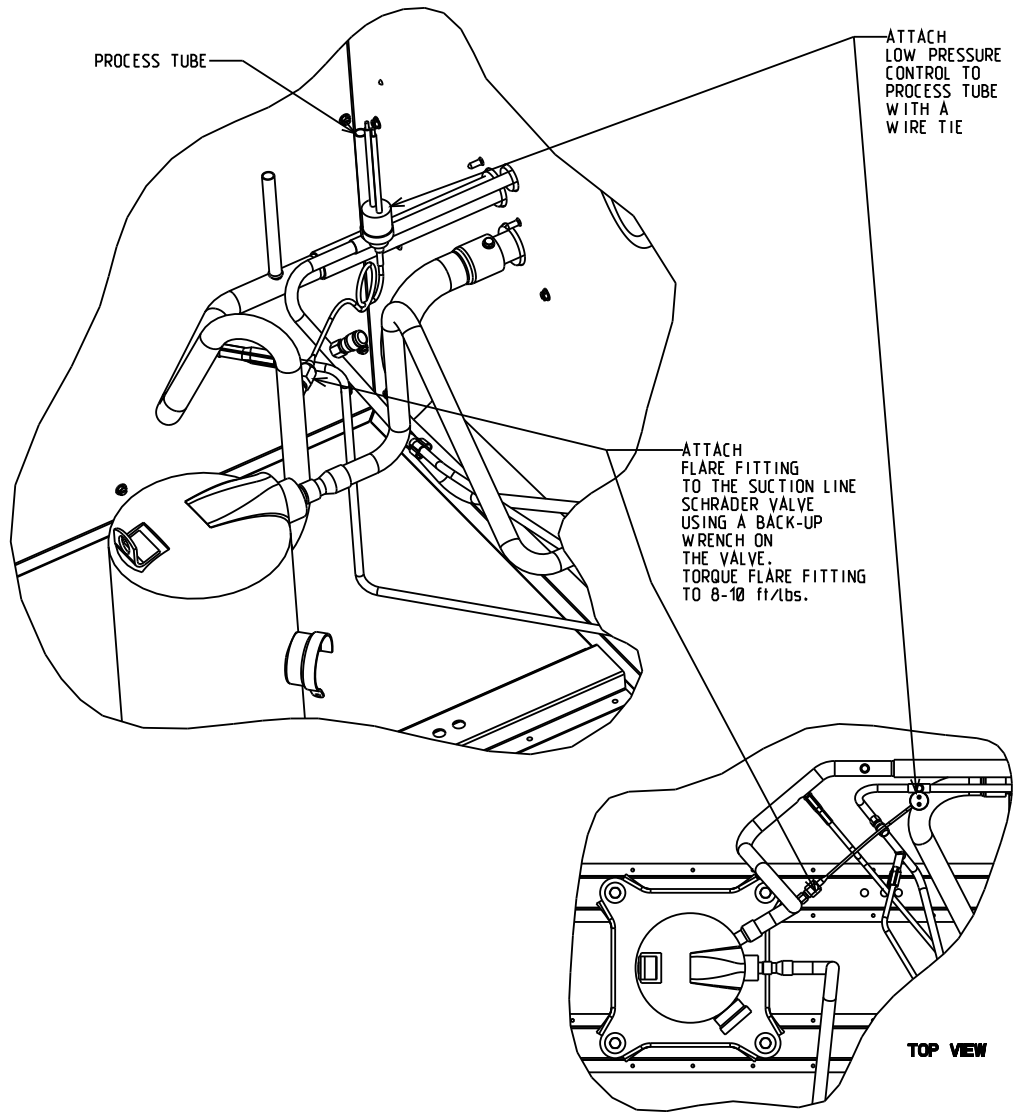

FIGURE 2
WIRING DIAGRAM

