

[-]CHJ

Parts List Multiflex Cased or Uncased Indoor Coils

Series J Sizes 24-61

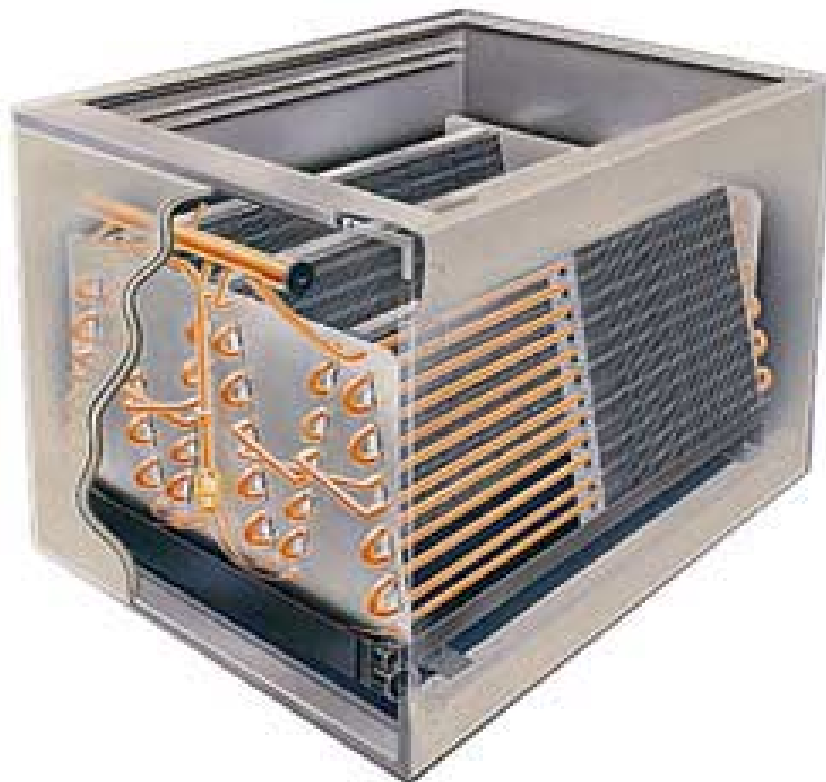

TABLE OF CONTENTS

Notes	Page 2
Model Number Explanation	Page 3
Serial Number Explanation	Page 3
Exploded View	Page 4
Coil Casing - Single Row Coils (24-36-48-60)	Page 5
Coil Casing - Double Stacked Coils (51-61)	Page 6

ORDERING, STOCKING AND NOTE EXPLANATIONS

Ordering Instructions:

When ordering a replacement part, be sure to read all notes and symbol notations on the parts list. In some cases, it is necessary to determine the unit style number and/or serial number in addition to the model number before selecting a replacement part. When ordering painted cabinet parts, the order **must specify** unit model number, serial number, and paint color. Also, your order can be processed more rapidly if you show the part number and description. Once the product is out of current production, price and availability will vary.

Replacement Parts Stocking Information:

As a general rule, most parts are in stock or have a short order period as long as the product is in current production. Once the product is out of current production price and availability will vary.

Note Explanation:

np = This part is not shown in exploded view. [no picture]
dna = **D**oes **n**ot **a**pply

MODEL NUMBER EXPLANATION

[-]	C	H	J	-	3	6	A	1	A	D	1	4	A
(1)	(2)	(3)	(4)		(5)	(6)	(7)	(8)	(9)	(10)			

(1) TRADEBRAND IDENTIFICATION

(2) MODEL

C = COIL

(3) TYPE

H = Type of Coil
(H=Expansion Valve Heat Pump)

(4) DESIGN SERIES / VARIATION

J = High Efficiency

(5) NOMINAL CAPACITY

24	=	18,000-24,000 BTUH
36	=	30,000-36,000 BTUH
48	=	42,000 BTUH
51	=	48,000 BTUH
60	=	60,000 BTUH
61	=	60,000 BTUH

(6) METERING DEVICE

A1 or A2 = TX Valve

(7) REFRIGERANT CONNECTIONS

A = Side Connections

G = Front Connections

NOTE:	[-]CHJ-51A1 & [-]CHJ-61A1 available in SIDE Connection Only. Cannot be ordered uncased.
--------------	--

(8) AIRFLOW

"A" CONNECTION (SIDE)

- U = Upflow/Downflow - Left
- D = Upflow/Downflow - Right
- L = Horizontal - Left - Top
- R = Horizontal - Right - Top
- S = Upflow/Downflow - Left or Right

"G" CONNECTION (FRONT)

- G = Upflow/Downflow
- H = Horizontal - Left
- Z = Horizontal - Right

(9) COIL CASING

- 14 = 14.0"
- 17 = 17.5"
- 21 = 21.0"
- 24 = 24.5"

(10) VARIATION

- Blank = None
- A = Filter/Filter Rack
- B = Adapters (78%/80% Furnace)
- X = Unit has Insulation

SERIAL NUMBER EXPLANATION

F	2	6	0	2	0	0	0	0	1
(1)	(2)	(3)						(4)	

(1) PRODUCTION LOCATION

- F = Fort Smith, AR
- M = Milledgeville, GA
- D = Dewey, OK
- T = Trenton, SC

(2) WEEK OF MANUFACTURE

(3) YEAR OF MANUFACTURE

(4) SEQUENTIAL PRODUCTION NUMBER

EXPLODED VIEW

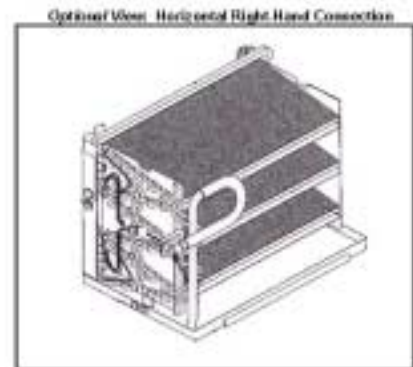
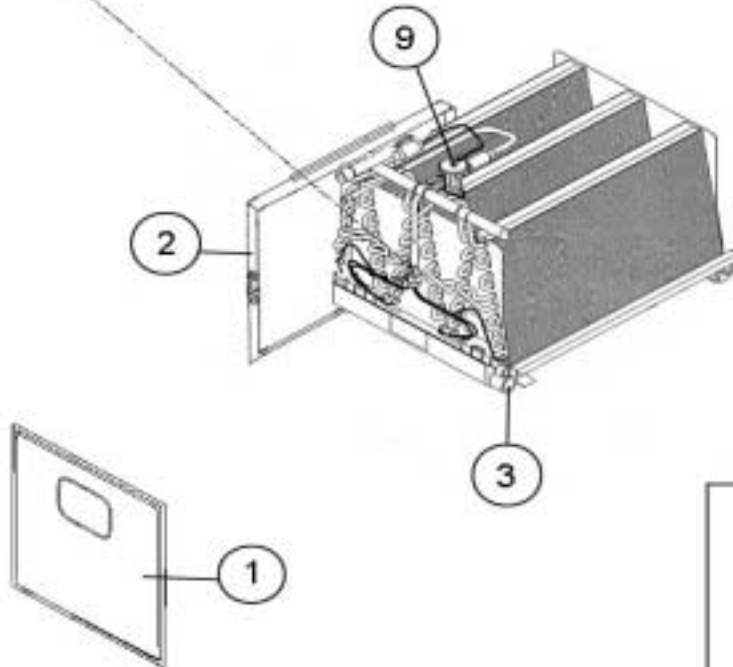
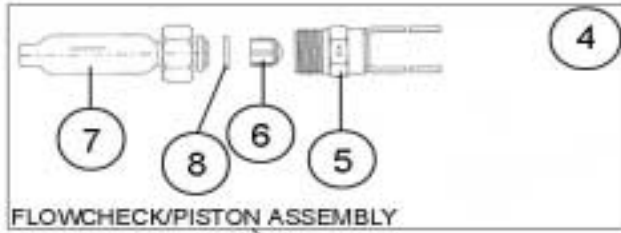

NO.	MODEL NOMINAL CAPACITY (Single Row Coil)	[-]CHJ 24	[-]CHJ 36	[-]CHJ 48	[-]CHJ 60
<i>NOTE: Individual Slabs Not Sold Separately</i>					
DOOR SECTION					
Example: [-]CHJ-24A1AD14A (Refrigerant Connection section in black lettering)					
"A"					
1	DOOR PANEL	AS-58380-04	AS-58380-08	AS-58380-13	AS-58380-13
"G"					
1	DOOR PANEL	AS-58380-19	AS-58380-20	AS-58380-21	AS-58380-21
DRAIN PAN SECTION					
Example: [-]CHJ-24A1AD14A (Refrigerant Connection section in black lettering)					
"A"					
2	DRAIN PAN	AE-59193-02	AE-59193-07	AE-59193-08	AE-59193-08
np	3/4" PVC STREET ELBOW	68-23534-01	68-23534-01	68-23534-01	68-23534-01
3	HORIZONTAL DRAIN PAN	AE-59192-01	AE-59192-01	AE-59192-01	AE-59192-01
np	DRAIN PAN EXTENSION ASSEMBLY	AS-57535-04	AS-57535-04	AS-57535-04	AS-57535-04
"G"					
2	DRAIN PAN	AE-59193-06	AE-59193-07	AE-59193-08	AE-59193-08
np	3/4" PVC STREET ELBOW	68-23534-01	68-23534-01	68-23534-01	68-23534-01
3	HORIZONTAL DRAIN PAN	AE-59192-01	AE-59192-01	AE-59192-01	AE-59192-01
np	DRAIN PAN EXTENSION ASSEMBLY	AS-57535-04	AS-57535-04	AS-57535-04	AS-57535-04
METERING SECTION					
Example: [-]CHJ-24A1AD14A (Metering/Refrigerant Connection section in black lettering)					
A1A, A1G					
4	FLOWCHECK/PISTON ASSEMBLY	61-26106-09	61-26108-14	61-26110-14	61-26110-17
5	DISTRIBUTOR	61-27100-29	61-27100-43	61-27100-58	61-27100-58
6	PISTON KIT	61-22613-09	61-22613-14	61-22613-14	61-22613-17
7	STRAINER	83-26020-01	83-26020-01	83-26020-01	83-26020-01
8	TFE WASHER	68-25024-01	68-25024-01	68-25024-01	68-25024-01
9	EXPANSION VALVE	61-26018-06	61-26018-05	61-26018-11	61-26018-22
A2A, A2G					
4	FLOWCHECK/PISTON ASSEMBLY	61-26106-12	61-26108-14	61-26110-15	
5	DISTRIBUTOR	61-27100-29	61-27100-43	61-27100-58	
6	PISTON KIT	61-22613-12	61-22613-14	61-22613-15	
7	STRAINER	83-26020-01	83-26020-01	83-26020-01	
8	TFE WASHER	68-25024-01	68-25024-01	68-25024-01	
9	EXPANSION VALVE	61-26018-04	61-26018-02	61-26018-11	

NO.	MODEL NOMINAL CAPACITY (Double Stacked Coil)	[-]CHJ 51	[-]CHJ 61
<i>NOTE: Individual Slabs Not Sold Separately</i>			
DOOR SECTION			
Example: [-]CHJ-51A1AL14A (Refrigerant/Airflow Connection section in black lettering)			
1	DOOR PANEL: AL, AS, AU	AS-58380-13	AS-58380-13
DRAIN PAN SECTION			
Example: [-]CHJ-24A1AL14A (Refrigerant Connection section in black lettering)			
	"A"		
2	DRAIN PAN	AE-59193-08	AE-59193-08
np	3/4" PVC STREET ELBOW	68-23534-01	68-23534-01
3	HORIZONTAL DRAIN PAN	AE-59192-01	AE-59192-01
np	DRAIN PAN EXTENSION ASSEMBLY	AS-57535-04	AS-57535-04
COIL SECTION			
	COIL #1 (Lower)	AS-59194-03	AS-59194-05
4	FLOWCHECK/PISTON ASSEMBLY	61-26110-12	61-26110-14
5	DISTRIBUTOR	61-27100-58	61-27100-58
6	PISTON	61-22613-12	61-22613-14
7	STRAINER	83-26020-01	83-26020-01
8	TFE WASHER	68-25024-01	68-25024-01
9	EXPANSION VALVE	61-26018-02	61-26018-11
	COIL #2 (Upper)	AS-59194-04	AS-59194-06
4	FLOWCHECK/PISTON ASSEMBLY	61-26110-08	61-26110-08
5	DISTRIBUTOR	61-27100-58	61-27100-58
6	PISTON	61-22613-08	61-22613-08
7	STRAINER	83-26020-01	83-26020-01
8	TFE WASHER	68-25024-01	68-25024-01
9	EXPANSION VALVE	61-26018-06	61-26018-06

NOTES

Printed in U.S.A.

Air Conditioning Division
P.O. Box 17010
Fort Smith, AR 72917-7010

September 2002
92-24326-22R-00