

# Lossnay Energy Recovery Ventilator

Models:

**LGH-F300RX<sub>5</sub>-E, LGH-F470RX<sub>5</sub>-E, LGH-F600RX<sub>5</sub>-E, LGH-F1200RX<sub>5</sub>-E**

## Operating Instructions







(For the user)



Please read this manual carefully before use for proper and safe use.

**Do not attempt to install the product by yourself.**

## Safety precautions

The following signs indicate that death or serious injury may be caused by failure to heed the precautions described below.

 <b>WARNING</b>	
 Prohibited	<b>Do not turn the remote controller on or off when flammable gas has leaked.</b> (It could catch fire or cause explosion with sparks released from electric contactor.) Open windows to ventilate.
 Do not disassemble	<b>Do not modify or disassemble.</b> (It could cause fire, electric shock or injury.)
 Do not wet	<b>Do not apply water to the unit and remote controller.</b> (Electrical shock can result.)
 Do not touch	<b>Do not poke your fingers or sticks into the air intake and outlet while the product is operating.</b> (Failure to heed this warning may result in injury.)
 Wet hands prohibited	<b>Don't operate with wet hands.</b> (Electrical shock can result.)
 The instructions given must be followed.	<b>Use the specified power supply and voltage.</b> (Use of incorrect power supply could cause fire or electric shock.) <b>Make sure the power supply isolator is turned off on the power distribution panel before starting maintenance.</b> (It could cause electric shock or injury if it is turned on.) <b>When any abnormal conditions (burning smell, or others) are observed, stop operation, turn off the power supply isolator on the power distribution panel and consult your dealer.</b> (Continuing operation under such conditions could cause, electric shock, fire, or damage.)

 <b>CAUTION</b>	
 Prohibited	<b>Do not place a burning appliance in a place where it is exposed directly to the wind from Lossnay.</b> (It could cause an accident as a result of incomplete combustion.) <b>Don't operate with the "BY-PASS" when heating the room in winter.</b> (Condensed water may drip from the unit and wet the surface of ceiling.) <b>Do not use at a place where exposed to high temperatures (104°F (40°C) or higher), naked flames, or in environment with heavy fumes.</b> (It could cause fire.) <b>Do not use in an environment such as a chemical factory, where hazardous gases such as acidic gases, alkaline gases, organic solvent fumes, paint fumes, or gases containing corrosive components are generated.</b> (It could malfunction.)
 The instructions given must be followed.	<b>Securely install parts after maintenance.</b> (It could cause injury if parts fall.) <b>Put on gloves during maintenance.</b> (It could cause injury.) <b>Make sure the power supply isolator is turned off on the power distribution panel when Lossnay is not used for a long period of time.</b> (It could cause electric shock, power leakage, or fire as a result of deteriorated insulation.) <b>The appliance is not to be used by children or persons with reduced physical, sensory or mental capabilities, or lack of experience and knowledge, unless they have been given supervision or instruction.</b> Children should be supervised to ensure that they do not play with the appliance.

## Names of the parts

### Models LGH-F300, F470, F600 RX<sub>5</sub>

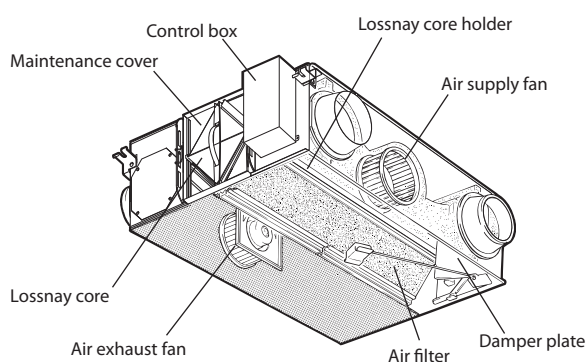

### Model LGH-F1200 RX<sub>5</sub>

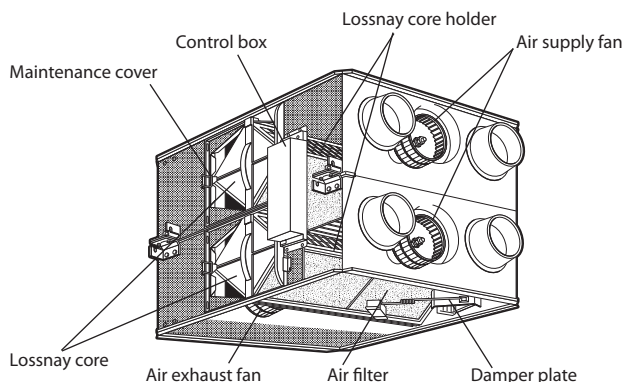

# Operation

Lossnay can be connected with Lossnay remote controllers (PZ-60DR-E, PZ-41SLB-E, PZ-52SF-E), and other Systems (City multi, Mr.slim, Central controller (MELANS))

Following shows the use of PZ-60DR-E, Please refer to the manuals for the other systems.

## For connection of a Lossnay remote controller (PZ-60DR-E)

If the Lossnay's operation is linked with the operation of an external device such as an air conditioner, the method of use will differ, so carry out the appropriate operation in accordance with the following table. Also, please see the installation and user's manual for the Lossnay remote controller (PZ-60DR-E).

### <If not connected to an external device> (PZ-41SLB-E can not be used together with PZ-60DR-E)

Example of System	Operation	Function
	Run using the remote controller.	<ul style="list-style-type: none"> <li>If 2 remote controllers are used, the last controller to be used has priority. (Last Command)</li> </ul>

### <If connected to an external device> (PZ-41SLB-E can not be used together with PZ-60DR-E)

	If an external device is connected the "On/Off" function of this device will also control the Lossnay operation.	<ul style="list-style-type: none"> <li>If you would like to turn ON the Lossnay alone while the external device is OFF, operate it by the Lossnay remote controller.</li> <li>The fan speed is on "High".</li> <li>The ventilation mode is "Ventilation Mode Auto Select".</li> </ul>

## ■ Display and Function button (PZ-60DR-E)

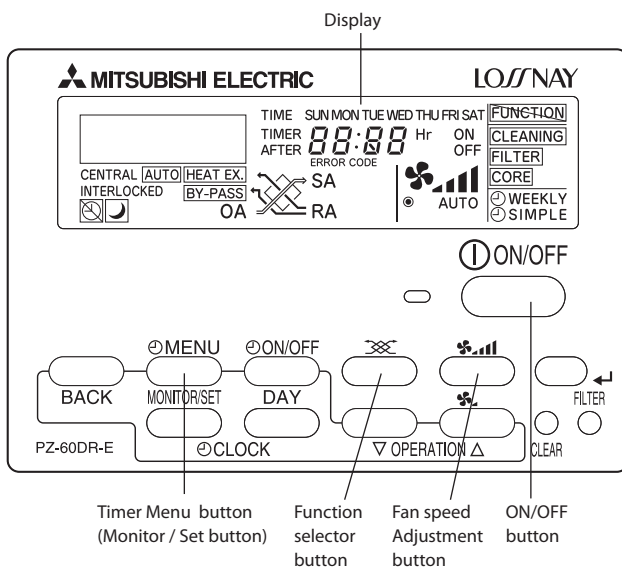

## ■ LOSSNAY ENERGY RECOVERY VENTILATE setting

Both fresh air supply and return air pass through the energy recovery cores. Resulting in total heat exchange. Energy recovery ventilation makes the fresh air temperature close to the indoor temperature in the winter and the summer season.

### Models LGH-F300, F470, F600 RXs Model LGH-F1200 RXs

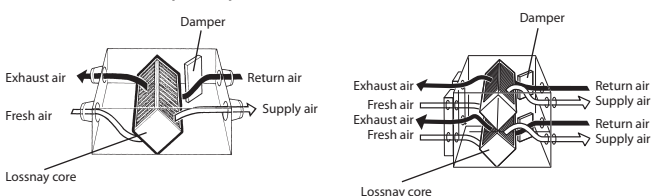

## ■ BY-PASS VENTILATE setting

The fresh air passes through the Lossnay cores and the return room air is exhausted direct. Lossnay bypass ventilate is normally operated during the spring/autumn months.

### Models LGH-F300, F470, F600 RXs Model LGH-F1200 RXs

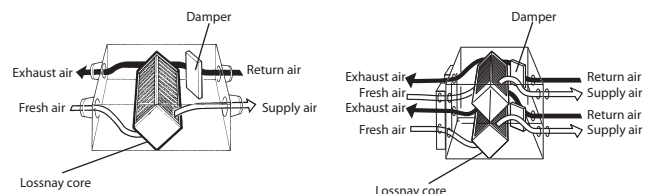

## ■ AUTOMATIC VENTILATION setting

The automatic damper mode automatically provides the correct ventilation for the conditions in the room. The following shows the effect "By-pass" ventilation will have under various conditions.

### 1. Reduces cooling load

If the air outside is cooler than the air inside the building during the cooling season (such as early morning or at night), "By-pass" ventilation will draw in the cooler outside air and reduce the cooling load on the system.

### 2. Night purge

"By-pass" ventilation can be used to release hot air from inside the building that has accumulated in buildings a business district during the hot summer season.

### 3. Office equipment room cooling

During cold season, fresh air can be drawn in and used as is to cool rooms where the temperature has risen due to the use of office equipment.

**⚠ In the case of "By-pass" ventilation, the supply air temperature slightly rises more than the outside air temperature because of the heat effect around the ducts or the unit motors.**

# Maintenance

Remove all dust and dirt on air filters and Lossnay cores at regular intervals in order to prevent a deterioration in the Lossnay functions.

- Guideline: Clean the air filters once a year.  
 (or when [FILTER] and [CLEANING] are indicated on the remote controller)
- Clean the Lossnay cores once two year.  
 (Clean the Lossnay cores once a year if possible.)  
 (Frequency should be increased depending on the extent of dirt.)

## Removing the parts

### 1) Maintenance cover

Locate and remove the cover fixing screw. Pull back the hinged clip. Open the door and lift off of the hinge brackets.

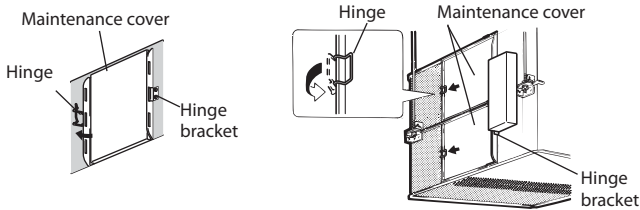

Models LGH-F300, F470, F600RXs    Model LGH-F1200RXs

### 2) Lossnay cores

Take hold of the handle and draw the Lossnay cores out from the main unit.

- Models LGH-F300, F470, F600 RXs: ..... 2 cores  
 Model LGH-F1200 RXs: ..... 4 cores

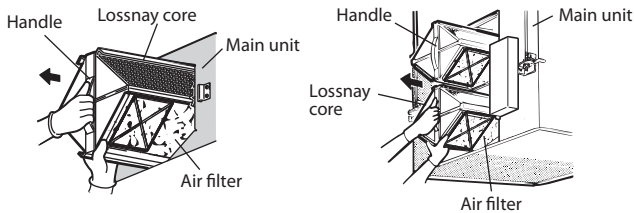

Models LGH-F300, F470, F600RXs    Model LGH-F1200RXs

### 3) Air filters

After pulling out the Lossnay cores, undo filter guides, then remove the air filters, located at the bottom left and right of the Lossnay cores, as below.

- Models LGH-F300, F470, F600 RXs: ..... 4 filters  
 Model LGH-F1200 RXs: ..... 8 filters

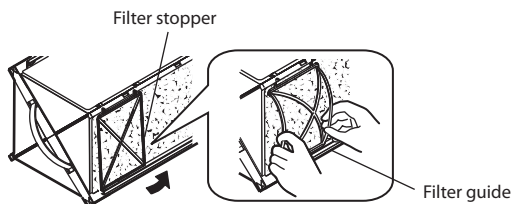

#### CAUTION

- Bow filter stoppers a little to remove them from filter guide.
- Take filter stoppers careful not to break them.

## Cleaning the parts

### 1) Air filters

Use a vacuum cleaner to remove light dust. To remove stubborn dirt wash in a mild solution of detergent and lukewarm water. (under 104°F (40°C))

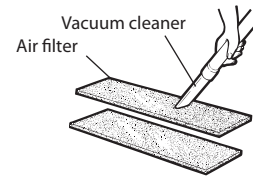

#### CAUTION

- Never wash the filters in very hot water and never wash them by rubbing them.
- Do not dry the filters by exposing them to a flame.

### 2) Lossnay cores

Use a vacuum cleaner to suck up the dust and dirt on the exposed surfaces of the Lossnay cores.  
 Use a soft brush only to clean exposed surface areas.

**Do NOT wash in water.**

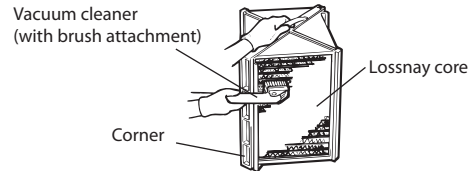

#### CAUTION

- Do not use the hard nozzle of the vacuum cleaner. It may damage the exposed surfaces of the Lossnay cores.
- Under no circumstances should the Lossnay cores be washed in water.

## Assembly after maintenance

Bearing in mind the following points, assemble the parts following the sequence for their removal in reverse.

- Arrange the Lossnay core with the air filter side downward.

#### Note

- If "FILTER" and "CLEANING" are indicated on the remote controller, turn off the indication, after maintenance.

# Specifications

Voltage (V) : 1-Phase 208 - 230

Model name	Line frequency (Hz)	Current (A)	Power consumption (W)	Air volume		Static pressure		Exchange efficiency (%)			Noise (dB(A))	Weight	
				(CFM)	(CMH)	(InH2O)	(Pa)	Temperature	Enthalpy		Below the unit	(lbs)	(kg)
									Heating	Cooling			
LGH-F300RXs	60	1.12 - 1.18	232 - 268	260 - 300	441 - 510	0.46 - 0.54	115 - 135	67.5 - 65.5	65 - 63	52 - 50	30.5 - 33	73	33
LGH-F470RXs	60	2.10 - 2.20	425 - 490	420 - 470	714 - 799	0.54 - 0.66	135 - 165	70.5 - 69	66 - 64	53 - 51	33 - 35.5	119	54
LGH-F600RXs	60	2.50 - 2.70	517 - 605	520 - 600	884 - 1020	0.48 - 0.48	120 - 120	68 - 67	65 - 64	53 - 50	34 - 36.5	132	60
LGH-F1200RXs	60	5.0 - 5.3	1040 - 1219	1012 - 1200	1720 - 2039	0.43 - 0.43	108 - 108	68 - 67	65 - 64	53 - 50	36 - 39	265	120

(1 mmH<sub>2</sub>O = 9.80665 Pa)

- \* The above values apply during Lossnay ventilation when the fan speed is set to high speed.
- \* The values given in the table for the noise level reflect the levels measured at a position 1.5 meters (1.64 yd) immediately below the unit in an anechoic chamber.
- \* Noise change or increase may occur because of the Bypass-Automatic function or Automatic fan speed change by timer setting.
- \* Temperature Exchange efficiency (%) are based on winter condition.

## After-sales servicing

Consult with your dealer about the after-sales services provided for this Lossnay product.

If you hear strange sounds, if no air is blown out or if some other trouble occurs, switch off the power and contact your dealer. Consult with your dealer concerning the cost of inspection or repair work.