

One piece all steel threaded fastening system for suspending steel threaded rod vertically overhead in pipe hanning, fire protection, electrical conduit and cable tray applications.

A universal socket driver is recommended to provide proper installation with a screw gun or hammer drill.

## THREADED ROD FASTENERS FOR WOOD

### BOTTOM MOUNT FOR WOOD

Self-tapping for use in wood with or without sheetrock



| ITEM #   | ROD SIZE | SHANK DIA. | SHANK LENGTH | MAX. PIPE SIZE | LOAD CAPACITY | LISTING |
|----------|----------|------------|--------------|----------------|---------------|---------|
| 2530314V | 3/8"-16  | 1/4"       | 1"           | 4"             | 1,500lbs      |         |
| 2530315V | 3/8"-16  | 1/4"       | 2"           | 4"             | 1,500 lbs     | UL      |
| 2530316V | 3/8"-16  | 1/4"       | 3"           | 4"             | 1,500lbs      | UL      |
| 2530317V | 3/8"-16  | 1/4"       | 4"           | 4"             | 1,500 lbs     | UL      |

| ITEM #   | ROD SIZE | SHANK DIA. | SHANK LENGTH | MAX. PIPE SIZE | LOAD CAPACITY | LISTING |
|----------|----------|------------|--------------|----------------|---------------|---------|
| 2530314V | 3/8"-16  | 1/4"       | 1"           | 4"             | 1,500lbs      |         |
| 2530315V | 3/8"-16  | 1/4"       | 2"           | 4"             | 1,500 lbs     | UL      |
| 2530316V | 3/8"-16  | 1/4"       | 3"           | 4"             | 1,500lbs      | UL      |
| 2530317V | 3/8"-16  | 1/4"       | 4"           | 4"             | 1,500 lbs     | UL      |



### NUT DRIVER

Recommended to be installed with Universal Steel & Wood Nut Driver (ITEM #2530324V)

2" nominal width (1-1/2")

**Bottom Mount**  
Install in center of lower face of beam or joist.

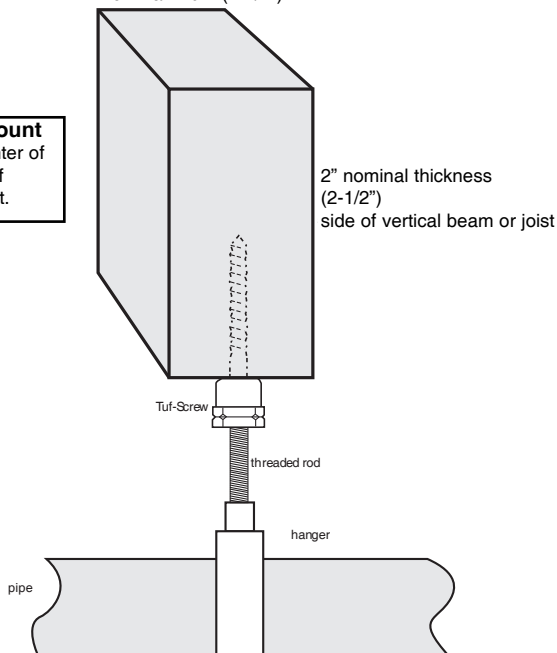

### INSTALLTION INSTRUCTIONS for Wood Bottom Mount

1. Insert nut driver into a 3/8" drill.
2. Insert Tuf Screw into the nut driver.
3. Position drill and begin to install. Drill should be in vertical position.
4. When nut driver spins freely on the cap of Tuf Screw, installation is complete.
5. Tuf Screw is now ready to receive threaded rod or bolt.

### CROSS REFERENCE

| ITEM #    | ITW SAMMY  |
|-----------|------------|
| 2530314V  | GST-10     |
| 2530315V  | GST-20     |
| 2530315BA | GST-25-380 |
| 2530316V  | GST-30     |
| 2530317V  | GST-40     |

# data sheet

## ARGCO



### THREADED ROD FASTENERS FOR WOOD

#### SIDE MOUNT FOR WOOD

- Self drilling and threading into wood
- No predrilling required

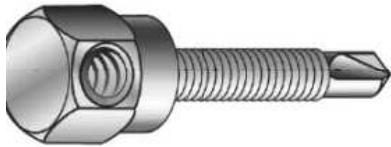

| ITEM #   | ROD SIZE | SHANK DIA. | SHANK LENGTH | EMBEDMENT DEPTH | MAX. PIPE SIZE | LOAD CAPACITY | LISTING |
|----------|----------|------------|--------------|-----------------|----------------|---------------|---------|
| 2530511V | 3/8"-16  | 1/4"       | 1"           | 1"              | 4"             | 1,500 lbs     | UL      |
| 2530513V | 3/8"-16  | 1/4"       | 2"           | 2"              | 4"             | 1,500 lbs     | UL      |
| 2530514V | 3/8"-16  | 5/16"      | 2-1/2"       | 2-1/2"          | 4"             | 1,500 lbs     | UL      |



#### NUT DRIVER

Recommended to be installed with  
Universal Steel & Wood Nut Driver  
(ITEM #2530324V)

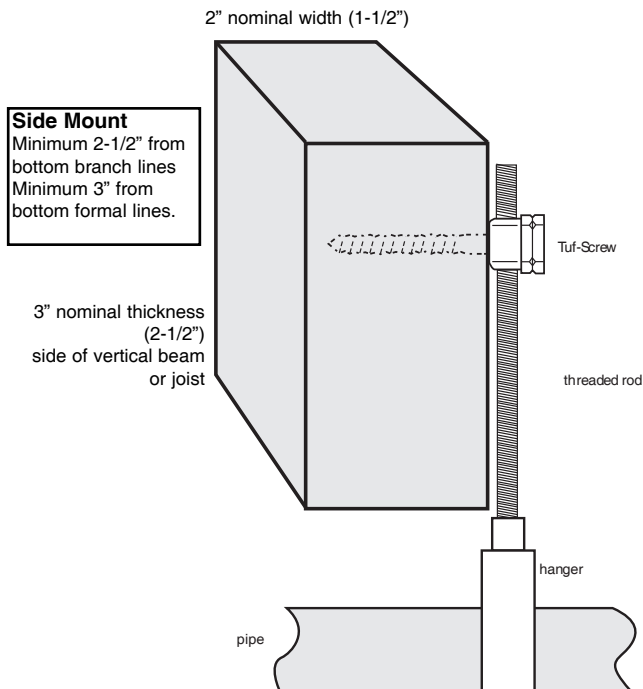

#### INSTALLTION INSTRUCTIONS for Wood Side Mount

1. Insert nut driver into a 3/8" drill.
2. Insert Tuf Screw into the nut driver.
3. Drill should be in horizontal position at a right angle to structural member.
4. When nut driver spins freely on the cap of Tuf Screw, installation is complete.
5. Tuf Screw is now ready to receive threaded rod or bolt.

#### CROSS REFERENCE

| ITEM #   | ITW SAMMY<br>SUPERSCREW® |
|----------|--------------------------|
| 2530511V | SWG-10                   |
| 2530513V | SWG-20                   |
| 2530514V | SWG25-380                |