

Submittal

Wall Mount Air Handlers 2 Tons With Factory Installed 5 KW Heater

AC models
GMU2APB24051SA

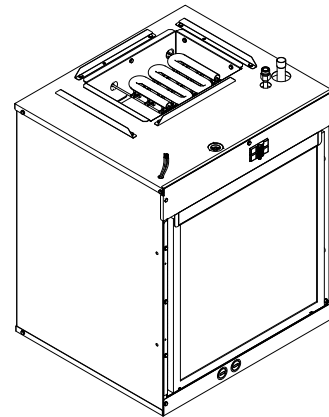

The GMU and GMV series air handlers are designed for wall mount or flush mount installations in a closet, utility room, alcove, or basement. These versatile units are applicable to air conditioning and heat pump applications. Several models are available to meet the specific requirements of the outdoor equipment. Electric resistance heaters are factory installed.

TAG: _____

▲ SAFETY WARNING

Only qualified personnel should install and service the equipment. The installation, starting up, and servicing of heating, ventilating, and air-conditioning equipment can be hazardous and requires specific knowledge and training. Improperly installed, adjusted or altered equipment by an unqualified person could result in death or serious injury. When working on the equipment, observe all precautions in the literature and on the tags, stickers, and labels that are attached to the equipment.

Outline Drawing

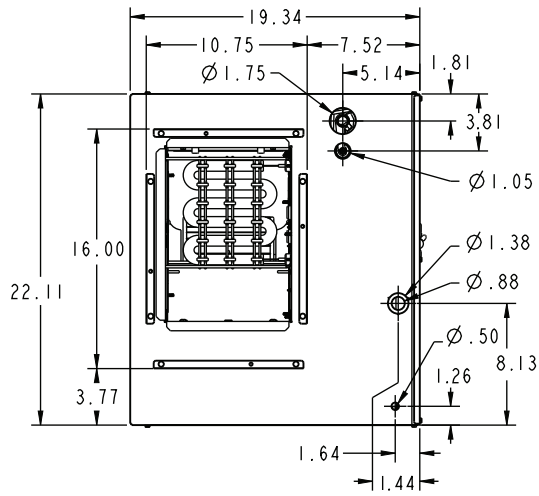

| Minimum Unit Clearance Table | | |
|---------------------------------|------------------------------------|---------------------------------|
| | To Combustible Material (Required) | Service Clearance (Recommended) |
| Sides | 0" | 0" |
| Front | 0" | 21" |
| Back | 0" | 0" |
| Outlet Duct & Plenum | 0" | N/A |
| Condensate Piping Below Cabinet | N/A | 3" |
| TXV/Orifice Above Unit | N/A | 9" |

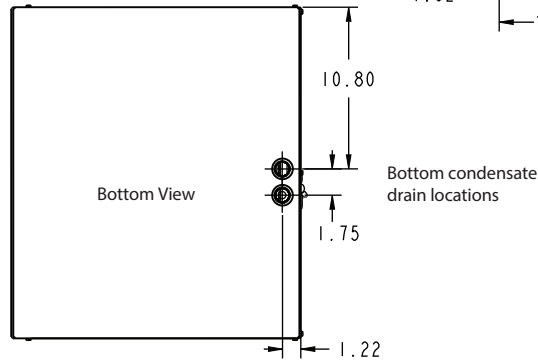
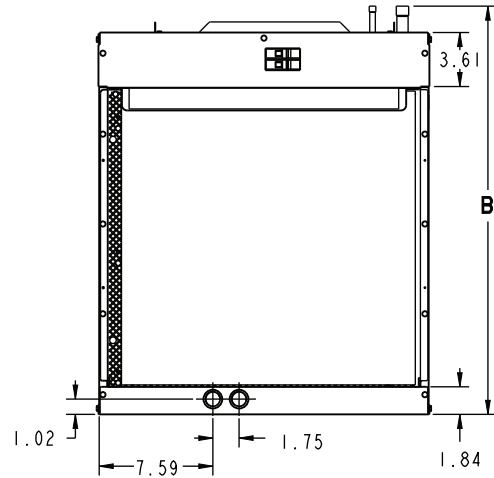
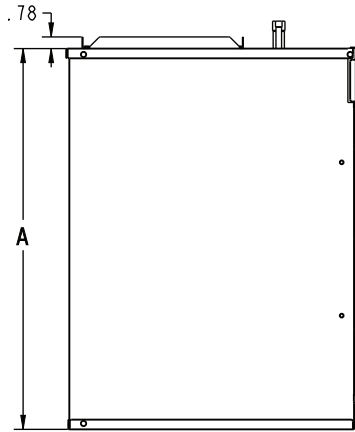

| PRODUCT DIMENSIONS | | | | | |
|--------------------------------|-------|-------|----------------|-------------------|-------------|
| Air Handler Model | A | B | Gas Line Braze | Liquid Line Braze | Filter Size |
| GMU2APB24051SA, GMU2APB24081SA | 25.43 | 27.26 | 3/4 | 3/8 | 20 x 20 x 1 |
| All dimensions are in inches | | | | | |

Performance and Electrical Data

| GMU2APB24051SA, GMU2APB24081SA | | | | | | |
|--------------------------------|------------------------|-------|-------|------------------------|-------|-------|
| External Static (in w.g.) | Airflow | | | | | |
| | Speed Taps - 230 Volts | | | Speed Taps - 208 Volts | | |
| | High | Med † | Low | High | Med † | Low |
| 0.1 | 1005.7 | 784.1 | 615.3 | 898.4 | 670.7 | 520.9 |
| 0.2 | 950.2 | 763.7 | 597.6 | 869.2 | 661.1 | 503.7 |
| 0.3 | 895.4 | 729.2 | 558.1 | 826.9 | 636.3 | 466.6 |
| 0.4 | 776.7 | 629.4 | 466.0 | 715.7 | 550.9 | 382.2 |
| 0.5 | 594.2 | 464.5 | 321.3 | 535.6 | 405.0 | 250.6 |
| 0.6 | 347.8 | 234.4 | | 286.7 | 198.5 | |

Note:

1. Shaded boxes represent airflow outside the required 300-450 CFM/ton
2. Values are wet coil, no filter
3. CFM correction for dry coil = Add 3%
4. † = Factory default setting

| Model No. | Heater Model No. | Number of Circuits / Phases | Motor Amps | Minimum Blower Speed | | 240 Volt | | | | |
|----------------|------------------|-----------------------------|------------|----------------------|----------------|----------|-------|-------------------------|--------------------------|-----------------------------|
| | | | | Without Heat Pump | With Heat Pump | Capacity | | Heater Amps per Circuit | Minimum Circuit Ampacity | Maximum Overload Protection |
| | | | | | | kW | BTUH | | | |
| GMU2APB24051SA | BAYHTRG605BRK | 1/1 | 0.9 | Low | N/A | 4.8 | 16400 | 20 | 26 | 30 |
| Model No. | Heater Model No. | Number of Circuits / Phases | Motor Amps | Minimum Blower Speed | | 208 Volt | | | | |
| | | | | Without Heat Pump | With Heat Pump | Capacity | | Heater Amps per Circuit | Minimum Circuit Ampacity | Maximum Overload Protection |
| | | | | | | kW | BTUH | | | |
| GMU2APB24051SA | BAYHTRG605BRK | 1/1 | 0.9 | Low | N/A | 3.6 | 12300 | 17.3 | 23 | 25 |

Fixed Orifice Superheat Charging Table

| | Indoor Wet Bulb Temp (F) | | | | | | | | | | | | | | | | | | | | | | | | | | | | | | | |
|----------------------------------|--------------------------|----|----|----|----|----|----|----|----|----|----|----|----|----|----|----|----|----|----|----|----|----|----|----|----|----|----|----|----|--|--|--|
| | 50 | 51 | 52 | 53 | 54 | 55 | 56 | 57 | 58 | 59 | 60 | 61 | 62 | 63 | 64 | 65 | 66 | 67 | 68 | 69 | 70 | 71 | 72 | 73 | 74 | 75 | 76 | 77 | 78 | | | |
| Outdoor Dry Bulb Temperature (F) | 55 | 7 | 9 | 10 | 11 | 12 | 14 | 15 | 17 | 18 | 20 | 21 | 23 | 24 | 26 | 27 | 29 | 30 | | | | | | | | | | | | | | |
| | 60 | 5 | 7 | 8 | 9 | 10 | 12 | 13 | 15 | 16 | 18 | 19 | 21 | 22 | 24 | 25 | 27 | 28 | 30 | 31 | | | | | | | | | | | | |
| | 65 | | | 4 | 6 | 8 | 10 | 11 | 13 | 14 | 16 | 17 | 18 | 19 | 21 | 22 | 24 | 25 | 27 | 28 | 27 | 31 | | | | | | | | | | |
| | 70 | | | | 5 | 7 | 8 | 10 | 11 | 13 | 14 | 16 | 17 | 18 | 19 | 21 | 22 | 24 | 25 | 27 | 28 | 30 | 31 | | | | | | | | | |
| | 75 | | | | | 5 | 6 | 7 | 9 | 10 | 12 | 14 | 16 | 18 | 19 | 21 | 22 | 24 | 26 | 28 | 29 | 31 | 32 | | | | | | | | | |
| | 80 | | | | | | | 4 | 6 | 7 | 9 | 10 | 11 | 12 | 14 | 16 | 18 | 19 | 21 | 23 | 25 | 26 | 28 | 29 | 31 | 33 | | | | | | |
| | 85 | | | | | | | | 4 | 6 | 7 | 9 | 10 | 13 | 14 | 16 | 18 | 20 | 21 | 23 | 24 | 26 | 28 | 29 | 30 | 31 | 32 | | | | | |
| | 90 | | | | | | | | | | 4 | 6 | 8 | 10 | 11 | 13 | 14 | 16 | 18 | 20 | 22 | 24 | 25 | 27 | 28 | 30 | 31 | | | | | |
| | 95 | | | | | | | | | | | | 4 | 6 | 8 | 10 | 13 | 14 | 16 | 18 | 20 | 22 | 23 | 25 | 26 | 28 | 29 | | | | | |
| | 100 | | | | | | | | | | | | | | | 6 | 8 | 10 | 12 | 13 | 16 | 18 | 20 | 21 | 23 | 25 | 27 | 29 | | | | |
| | 105 | | | | | | | | | | | | | | | 4 | 6 | 7 | 9 | 11 | 13 | 15 | 18 | 20 | 22 | 24 | 26 | 28 | | | | |
| | 110 | | | | | | | | | | | | | | | | | 4 | 7 | 9 | 11 | 13 | 16 | 18 | 21 | 23 | 26 | 28 | | | | |
| | 115 | | | | | | | | | | | | | | | | | | | 6 | 9 | 12 | 14 | 16 | 19 | 21 | 24 | 26 | | | | |

Using a digital psychrometer, measure the return air wet-bulb temperature at the unit just before the coil. Also measure the outdoor dry-bulb temperature. Use these temperatures to locate the target superheat on the charging table. Do not attempt to charge the system if these conditions fall outside of this charging table.
 ADD refrigerant to DECREASE total superheat. REMOVE refrigerant to INCREASE total superheat. Always allow 10 to 15 minutes of operation after any refrigerant or air flow change prior to determining the final superheat.

Product Specifications

| | |
|---|-------------------------|
| MODEL | GMU2APB24051SA |
| RATED VOLTS/PH/HZ | 208-230/1/60 |
| RATINGS | See O.D. Specifications |
| INDOOR COIL — TYPE | Plate Fin |
| Refrigerant Control | Orifice |
| Drain Conn. Size. (in.) | 3/4" NPT |
| FACTORY INSTALLED HEATER | 5 KW |
| DUCT CONNECTION | 10.75 x 16.00 |
| INDOOR MOTOR — TYPE | PSC |
| Diameter-Width (in.) | 10 — 6 |
| No. Used | 1 |
| Drive — No. Speeds | Direct — 3 |
| CFM vs. in.W.G. | See Airflow Table |
| No. Motors — HP | 1 — 1/8 |
| Motor Speed RPM | 825 |
| Volts/Ph/Hz | 208-230/1/60 |
| F.L. Amps | 0.9 |
| FILTER | |
| Filter Furnished? | Yes |
| Filter Size (in.) | 20 x 20 x 1 |
| REFRIGERANT | R-410A |
| Ref. Line Connections | Brazed |
| Coupling or Conn Size — in. Gas | 3/4 |
| Coupling or Conn Size — in. Liq. ^(a) | 3/8 |
| DIMENSIONS (HxWxD) | |
| Crated (in.) | 29 x 22.5 x 20 |
| Uncrated (in.) | 25.43 x 22.11 x 19.34 |
| WEIGHT | |
| Shipping / Net (lbs) | 70 / 67 |

^(a) Includes a mechanical fitting with a 3/8" braze connection

Features

Table 1. Standard Features

Table 2. Optional Accessories

| |
|---|
| <p>Use with all GMU2 and GMV2 models</p> <ul style="list-style-type: none"> • BAYTGM1WALLPNL — Wall Mount Panel Quantity 1 • BAYTGM5WALLPNL — Wall Mount Panel Quantity 5 <p>Use with GMU2APB24051SA, GMU2APB24081SA, GMV2APB26051SA, GMV2APB26081SA models</p> <ul style="list-style-type: none"> • BAYFRT5LVPNL26A — Louver Panel Quantity 5 • BAYFRT1LVPNL26A — Louver Panel Quantity 1 <p>Use with GMU2APB30081SA, GMU2AEB37101SA, GMV2APB32081SA, GMV2AEB39101SA models</p> <ul style="list-style-type: none"> • BAYFRT5LVPNL30A — Louver Panel Quantity 5 • BAYFRT1LVPNL30A — Louver Panel Quantity 1 |
|---|

Table 3. Optional Orifice Kits

| Outdoor Unit Capacity (Tons) | Orifice Size (R410A or R22) | Orifice Kit Number |
|------------------------------|-----------------------------|--------------------|
| 1.5 | 0.049 | BAYORIACH-P0049A |
| 2.0 | 0.057 | BAYORIACH-P0057A |
| 2.5 | 0.061 | BAYORIACH-P0061A |
| 3.0 | 0.067 | BAYORIACH-P0067A |



Ingersoll Rand (NYSE: IR) advances the quality of life by creating comfortable, sustainable and efficient environments. Our people and our family of brands — including Club Car®, Ingersoll Rand®, Thermo King® and Trane® — work together to enhance the quality and comfort of air in homes and buildings; transport and protect food and perishables; and increase industrial productivity and efficiency. We are a global business committed to a world of sustainable progress and enduring results.



ingersollrand.com



Ingersoll Rand has a policy of continuous product and product data improvements and reserves the right to change design and specifications without notice.
We are committed to using environmentally conscious print practices.